

# POIS 70 IP67

## LIGHT SOURCE

LED quantity	35
Power max	4W
Total lumen output (3000K)	131 lm
Efficacy lm/W (3000K)	33 lm/W
CRI	>80 – >90
LED Temperature	2700K - 3000K – 3000K CRI>90 - 4000K
Average operational life	50.000 hours

## OPTIC

Material	Polycarbonate
Available optics	Opal glass
Beam direction	Fixed
Flux symmetry	Symmetrical

## FIXTURE

Material	Aluminum, Tempered glass
Available finishes	Powder coated: 7 - White H - Black K - Corten 4Q- Agate gray 4A- Antracite gray MF- Moka B6 - Intense bronze
IP Rate	IP67
Working Temperature	-20° ÷ +40°
Integrated fixing Systems	-

## ELECTRICAL FEATURES

Driver	Remote
Dimmable	Push, 1-10V, DALI
Connection	In parallel at 24Vdc
Class	III

## MECHANICAL FEATURES

Dimensions	Ø69 x 44 mm
Weight	265 gr
Installation	Wall, ceiling mounting
Cut-out	-
Use	Outdoor

## ACCESSORIES

Visors	-
Filters	-
Box/ Frame	-
Fixing system	-

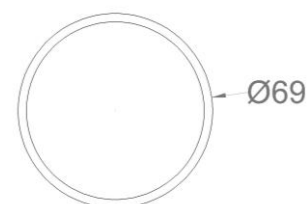
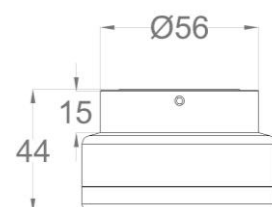

PHOTOMETRIC DATA

Opal glass – 4W						
						
H(m)	D(m)	E <sub>max</sub> (lx)	E <sub>av</sub> (lx)			
110°						
<u>0.60</u>	1.74	131	34			
<u>1.20</u>	3.48	33	9			
<u>1.80</u>	5.22	15	4			
<u>2.40</u>	6.96	8	2			
<u>3.00</u>	8.70	5	1			

NOTES

---

---