

## LIGHT SOURCE

LED quantity	3	
Power max	3 W	
Total lumen output (3000K)	3W: 10° - 315 lm 30° - 308 lm 60° - 269 lm	6W: 10° - 432 lm 30° - 424 lm 60° - 368 lm
Efficacy lm/W (3000K)	3W: 10° - 105 lm/W 30° - 103 lm/W 60° - 90 lm/W	6W: 10° - 72 lm/W 30° - 71 lm/W 60° - 62 lm/W
CRI	>80	
LED Temperature	2200K - 2700K - 3000K - 4000K - RGB	
Average operational life	50.000 hours	

## OPTIC

Material	PMMA
Available optics	10° - 30° - 60°
Beam direction	Fixed
Flux symmetry	Symmetrical

## FIXTURE

Material	Aluminum, Stainless Steel
Available finishes	Hard coat anodized: 3 - Gray 4 - Black As per material: 6 - Stainless steel AISI 316L
IP Rate	IP67
Working Temperature	-20° ÷ +40°
Integrated fixing Systems	-

## ELECTRICAL FEATURES

Driver	Remote
Dimmable	Push, 1-10V, DALI
Connection	In series at 350mA - 500mA
Class	III

## MECHANICAL FEATURES

Dimensions	Ø80 x 74 mm
Weight	320 gr
Installation	Wall, ceiling, floor recessed
Cut-out	Ø68 mm (recessed box A00766.40)
Use	Outdoor

## ACCESSORIES

Visors	-
Filters	-
Box/ Frame	Recessed box
Fixing system	-

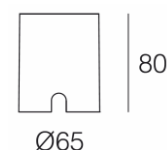
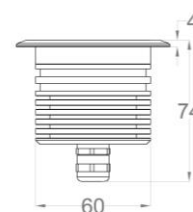
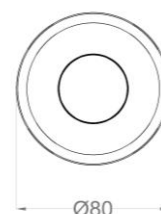

A00766.40 Recessed box

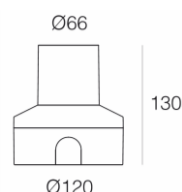

A00251.40 Recessed box

PHOTOMETRIC DATA

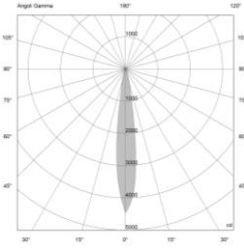
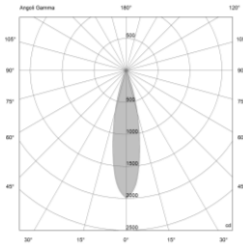
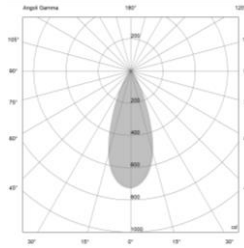
10° Lens – 6W	30° Lens – 6W	60° Lens – 6W																																																																																					
																																																																																							
<table><tr><th>H(m)</th><th>D(m)</th><th>E<sub>max</sub>(lx)</th><th>E<sub>av</sub>(lx)</th></tr><tr><td colspan="4"><b>10°</b></td></tr><tr><td><u>1.00</u></td><td>0.25</td><td>4476</td><td>2837</td></tr><tr><td><u>2.00</u></td><td>0.51</td><td>1119</td><td>709</td></tr><tr><td><u>3.00</u></td><td>0.76</td><td>497</td><td>315</td></tr><tr><td><u>4.00</u></td><td>1.02</td><td>280</td><td>177</td></tr><tr><td><u>5.00</u></td><td>1.27</td><td>179</td><td>113</td></tr></table>	H(m)	D(m)	E <sub>max</sub> (lx)	E <sub>av</sub> (lx)	<b>10°</b>				<u>1.00</u>	0.25	4476	2837	<u>2.00</u>	0.51	1119	709	<u>3.00</u>	0.76	497	315	<u>4.00</u>	1.02	280	177	<u>5.00</u>	1.27	179	113	<table><tr><th>H(m)</th><th>D(m)</th><th>E<sub>max</sub>(lx)</th><th>E<sub>av</sub>(lx)</th></tr><tr><td colspan="4"><b>30°</b></td></tr><tr><td><u>1.00</u></td><td>0.42</td><td>2000</td><td>1249</td></tr><tr><td><u>2.00</u></td><td>0.83</td><td>500</td><td>312</td></tr><tr><td><u>3.00</u></td><td>1.25</td><td>222</td><td>139</td></tr><tr><td><u>4.00</u></td><td>1.66</td><td>125</td><td>78</td></tr><tr><td><u>5.00</u></td><td>2.08</td><td>80</td><td>50</td></tr></table>	H(m)	D(m)	E <sub>max</sub> (lx)	E <sub>av</sub> (lx)	<b>30°</b>				<u>1.00</u>	0.42	2000	1249	<u>2.00</u>	0.83	500	312	<u>3.00</u>	1.25	222	139	<u>4.00</u>	1.66	125	78	<u>5.00</u>	2.08	80	50	<table><tr><th>H(m)</th><th>D(m)</th><th>E<sub>max</sub>(lx)</th><th>E<sub>av</sub>(lx)</th></tr><tr><td colspan="4"><b>60°</b></td></tr><tr><td><u>1.00</u></td><td>0.72</td><td>728</td><td>438</td></tr><tr><td><u>2.00</u></td><td>1.44</td><td>182</td><td>109</td></tr><tr><td><u>3.00</u></td><td>2.16</td><td>81</td><td>49</td></tr><tr><td><u>4.00</u></td><td>2.88</td><td>46</td><td>27</td></tr><tr><td><u>5.00</u></td><td>3.60</td><td>29</td><td>18</td></tr></table>	H(m)	D(m)	E <sub>max</sub> (lx)	E <sub>av</sub> (lx)	<b>60°</b>				<u>1.00</u>	0.72	728	438	<u>2.00</u>	1.44	182	109	<u>3.00</u>	2.16	81	49	<u>4.00</u>	2.88	46	27	<u>5.00</u>	3.60	29	18	
H(m)	D(m)	E <sub>max</sub> (lx)	E <sub>av</sub> (lx)																																																																																				
<b>10°</b>																																																																																							
<u>1.00</u>	0.25	4476	2837																																																																																				
<u>2.00</u>	0.51	1119	709																																																																																				
<u>3.00</u>	0.76	497	315																																																																																				
<u>4.00</u>	1.02	280	177																																																																																				
<u>5.00</u>	1.27	179	113																																																																																				
H(m)	D(m)	E <sub>max</sub> (lx)	E <sub>av</sub> (lx)																																																																																				
<b>30°</b>																																																																																							
<u>1.00</u>	0.42	2000	1249																																																																																				
<u>2.00</u>	0.83	500	312																																																																																				
<u>3.00</u>	1.25	222	139																																																																																				
<u>4.00</u>	1.66	125	78																																																																																				
<u>5.00</u>	2.08	80	50																																																																																				
H(m)	D(m)	E <sub>max</sub> (lx)	E <sub>av</sub> (lx)																																																																																				
<b>60°</b>																																																																																							
<u>1.00</u>	0.72	728	438																																																																																				
<u>2.00</u>	1.44	182	109																																																																																				
<u>3.00</u>	2.16	81	49																																																																																				
<u>4.00</u>	2.88	46	27																																																																																				
<u>5.00</u>	3.60	29	18																																																																																				

NOTES

Provided with 100 cm neoprene cable.