

NESIS H65 Am with hex louver

LIGHT SOURCE

LED quantity	3	
Power max	3 W	
Total lumen output (3000K)	3W:	6W:
	10° - 232 lm	10° - 319 lm
	30° - 205 lm	30° - 282 lm
	60° - 155 lm	60° - 214 lm
Efficacy lm/W (3000K)	3W:	6W:
	10° - 77 lm/W	10° - 53 lm/W
	30° - 68 lm/W	30° - 47 lm/W
	60° - 52 lm/W	60° - 36 lm/W
CRI	>80	
LED Temperature	2200K - 2700K - 3000K - 4000K - RGB	
Average operational life	50.000 hours	

OPTIC

Material	PMMA
Available optics	10° - 30° - 60°
Beam direction	Fixed
Flux symmetry	Symmetrical

FIXTURE

Material	Aluminum, Stainless Steel
Available finishes	Hard coat anodized:
	3 - Gray
	4 - Black
	As per material:
	6 - Stainless steel AISI 316L
IP Rate	IP67
Working Temperature	-20° ÷ +40°
Integrated fixing Systems	-

ELECTRICAL FEATURES

Driver	Remote
Dimmable	Push, 1-10V, DALI
Connection	In series at 350mA - 500mA
Class	III

MECHANICAL FEATURES

Dimensions	Ø80 x 74 mm
Weight	320 gr
Installation	Wall, ceiling, floor recessed
Cut-out	Ø68 mm (recessed box A00766.40)
Use	Outdoor

ACCESSORIES

Visors	-
Filters	-
Box/ Frame	Recessed box
Fixing system	-

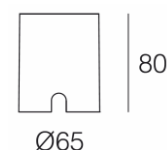
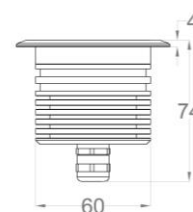
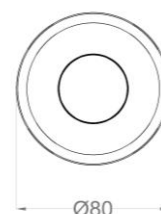

A00766.40 Recessed box

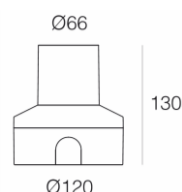

A00251.40 Recessed box

PHOTOMETRIC DATA

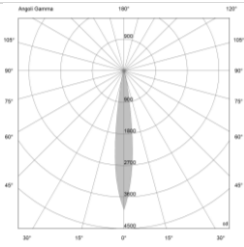
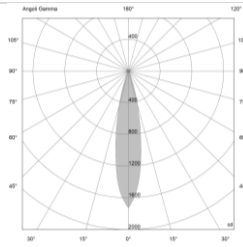
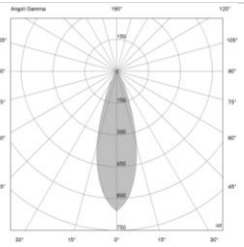
10° Lens – 6W				30° Lens – 6W				60° Lens – 6W			
											
H(m)	D(m)	E _{max} (lx)	E _{av} (lx)	H(m)	D(m)	E _{max} (lx)	E _{av} (lx)	H(m)	D(m)	E _{max} (lx)	E _{av} (lx)
10°				30°				60°			
<u>1.00</u>	0.25	3970	2493	<u>1.00</u>	0.37	1730	1066	<u>1.00</u>	0.58	661	393
<u>2.00</u>	0.49	992	623	<u>2.00</u>	0.74	433	266	<u>2.00</u>	1.15	165	98
<u>3.00</u>	0.74	441	277	<u>3.00</u>	1.11	192	118	<u>3.00</u>	1.73	73	44
<u>4.00</u>	0.98	248	156	<u>4.00</u>	1.48	108	67	<u>4.00</u>	2.30	41	25
<u>5.00</u>	1.23	159	100	<u>5.00</u>	1.85	69	43	<u>5.00</u>	2.88	26	16

NOTES

Provided with 100 cm neoprene cable.